



Door pictured is  
outward opening

## Securidor+ S2 Security Rated Steel Door-Set

- FIRE EXITS
- PERSONNEL DOORS

SUITABLE FOR SECURITY  
OF BUILDINGS

### UNIQUE RANGE FEATURES

4-6 weeks lead time

Up to 3m high

1 year warranty

Next day quote



Securidor+ S2 security door range comprises of single and double security-rated steel door-sets that are specifically designed for use in locations that would benefit from enhanced protection. The typical applications for this range includes leisure facilities, schools and universities, housing association communal areas and general retail outlets.

Please note that these door-sets can only be supplied with outward opening leaves

# Securidor® + LPS 1175: Level 2 Issue 7 Cert/LPCB ref. 1542a

## Securidor+ S2 Specification

### Leaf

Manufactured from 1.5mm galvanised attack face steel with 1.5mm inner face, the composite door leaf is 45mm thick with astragal lip to the closing edge. It weighs approximately 40kg per square metre.

### Frame

The welded frame is made from reinforced 1.5mm galvanised steel and a 38mm x 100mm single rebated profile. It is reinforced at the hinges, lock keeps and fixing points.

### Key Features

The range is certified to LPS1175 level 2, and fitted with double hinges for additional strength. It also incorporates an anti leverage cover strip to closing edge of door leaf. The door-sets are also Secured by Design approved and are also available with windows, louvres. Also solid over panels and hinged over panels which can be fixed, or removable.

### Threshold

Aluminium and Type H - see below.

### Hardware

Choice of Assa Sashlock, Assa Deadlock, or Exidor 700 series panic hardware available an optional Exidor outside access device. Also available with Surelock McGill Sterling's Heavy Duty Tower bolts on the passive leaf. Keys and cylinders can be registered to eliminate the chance of key copying.

### Finish

Wide choice of finishes available including powder coated finish from our range of RAL or BS colours.

### Optional Extras

AB26 vision panel 400 x 400 x 27mm  
Louvres

### Certification

Certified by the Loss Prevention Certification Board to LPS 1175 Level 2 Issue 7 Cert/LPCB Ref. 1542a

### Suitable Substrate

Structural timber or steelwork, blockwork or brickwork/ concrete blockwork.  
Minimum Fixing Size - M8



Secured by Design



Single Door Size	Double Door Size
Min 750 x 1800mm	Min 1500 x 1800mm
Max 1300 x 2210mm	Max 2200 x 2210mm

### Typical leaf and frame construction

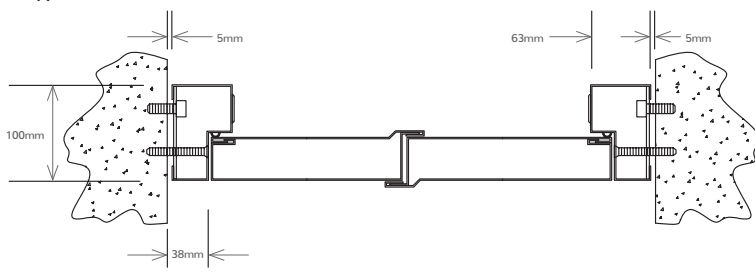

### Aluminium threshold with neoprene seal

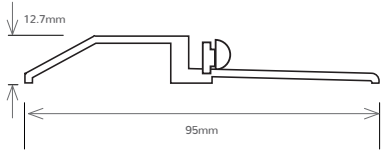

### Type H Threshold

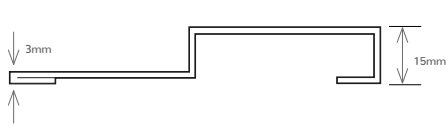

### Standard door types - other options available

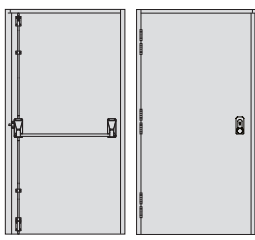

Single door

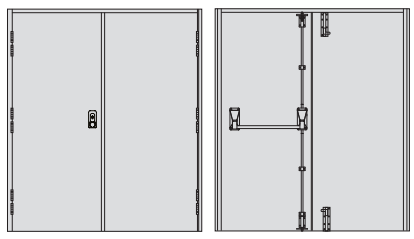

Double door