



SIDE AND TOP PANEL INSTALLATION INSTRUCTIONS

COMPONENTS

- | | |
|---------------------|-------------------|
| 1. Door Frame | 4. Side Panel |
| 2. Side Panel Frame | 5. Top Panel |
| 3. Top Panel Frame | 6. Expander Sides |

GENERAL RULES

Single door-sets are supplied fully assembled unless nonstandard frames were requested. Please refer to our standard installation instructions for frame assembly.

Double door-sets are supplied unbuilt so will require assembly and fitting in accordance with our standard installation instructions.

Side and top panels are supplied assembled for transportation purposes. Always remove the panel prior to installation.

All expander sides longer than 2500mm will come in 2 parts with a joining plate. The joining plate needs to be riveted or joined using supplied self-taping screws to the top expander only as shown in image.

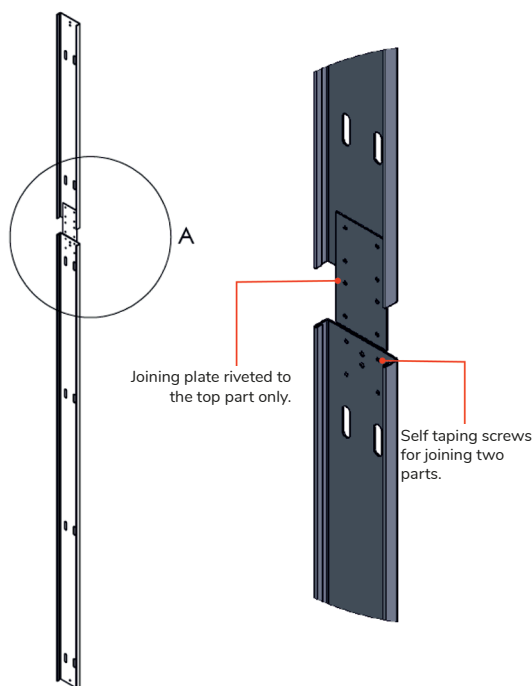
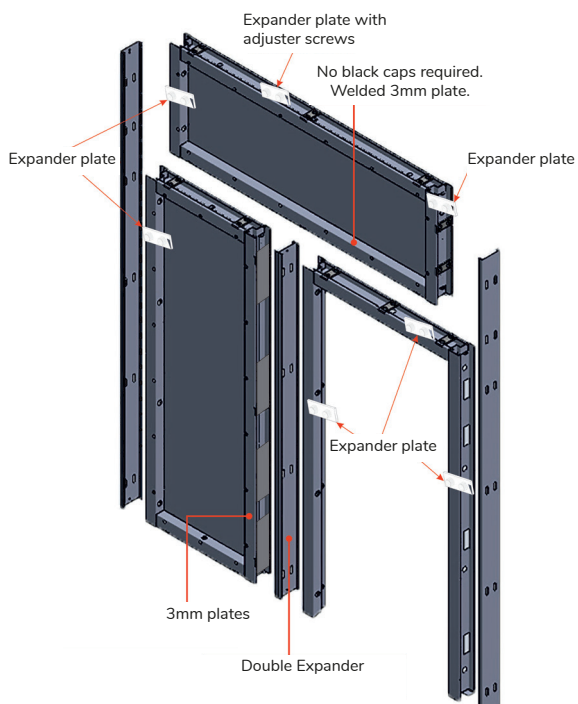
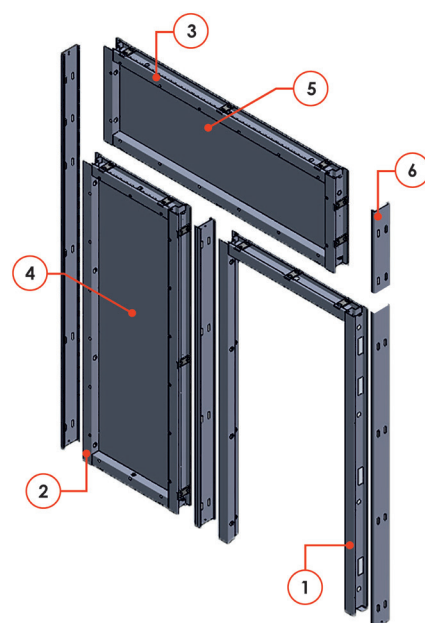

SIDE AND TOP PANEL INSTALLATION INSTRUCTIONS

TO INSTALL

1. If needed, assemble the door frame in accordance with our standard installation instruction booklet.
2. Both sides of the door frame and the header are supplied with expander plates and adjuster screws. Only the jamb being fixed into the wall will be supplied with an expander side. (Do not install the frame yet).
3. The side/top panel frame is manufactured with expander plates and adjuster screws on the sides that will be fitted to the structural surface with or without expander sides. The opposite sides will be manufactured with welded 3mm and these will align with the door frame expander plates with adjuster screws.
4. Remove your side/top panel from its frame before starting to assemble your door. Fixing screws are easily removable and should be carefully retained for re-assembly. When removing the panels, carefully set them aside to avoid damage.
5. To protect the powder coat we suggest you assemble the frame on a protected floor surface.
6. Place the door frame (with the door leaf removed) and side/top panel frame next to each other on a flat surface. Clamp them together ensuring they are fully aligned and the panel fixing screws are always from inside the room (option A or option B below).

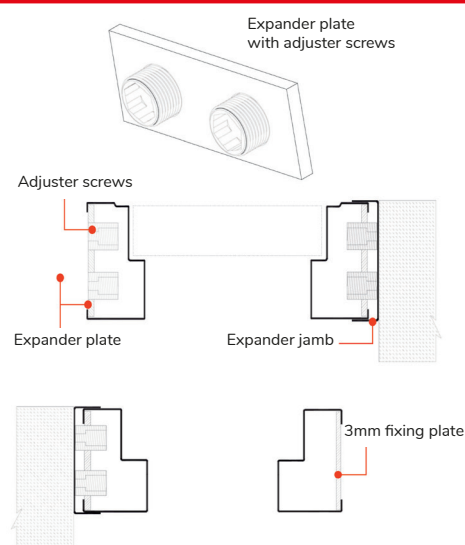

Option A: Outward Opening Leaf

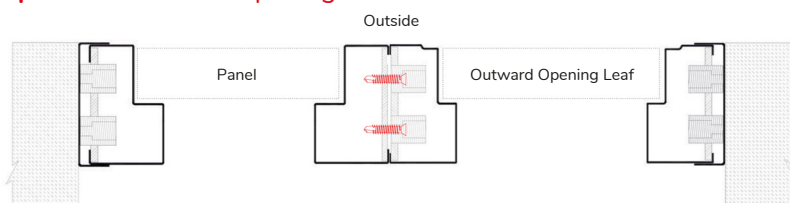

Option B: Inward Opening Leaf

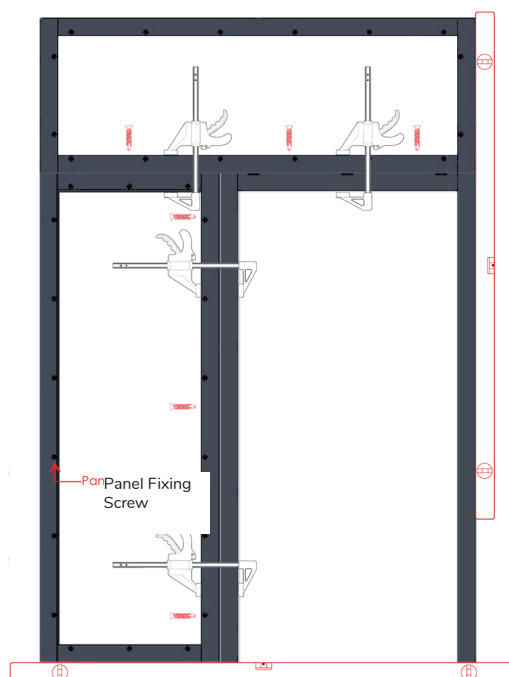
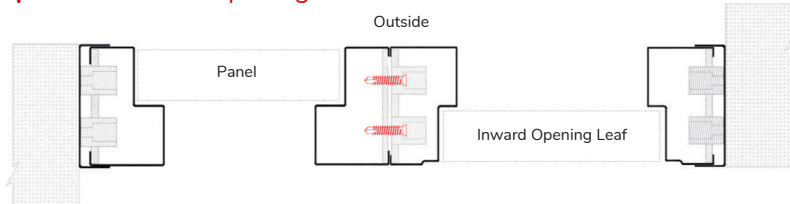



SIDE AND TOP PANEL INSTALLATION INSTRUCTIONS

7. Use the 6.3 x 50mm self-taping screws provided in the fixing kit to secure the door frame to the panel frame.
8. Follow the same steps to connect the top panel frame if required.
9. Once the door frame and the panel frame are connected, add the expander sides. Place the full frame assembly in the structural opening and commence fixing in accordance with the general installation instruction booklet provided with the door.
10. Once the frame is installed square and level, install the door leaf in accordance with the general installation instruction booklet and ensure the leaf operates correctly.
11. Reinstall the side/top panels within its four-sided frame, securing it in place using the provided M6x30mm machine screws. Close the fixing holes using the 14mm plastic cover caps that you can find in your fixing kit.

