



✓ Push bar to open

✓ Push bar to open



**Steel***dor* thermal

EMERGENCY EXIT

## DOUBLE STEEL DOOR-SET

SUITABLE FOR INTERNAL / EXTERNAL USE

T. 01524 727000 E. [sales@strongdor.com](mailto:sales@strongdor.com)  
[www.strongdor.com](http://www.strongdor.com)

UNIQUE  
RANGE  
FEATURES

10-12 day lead time

Up to 2.5m high\*

1 year warranty

Same day quote

Thermal Rockwool Core

2.0 W/m<sup>2</sup>K U-value



Assessed to BS ISO 9001:2015  
Cert. No.1542

Steeldor thermal was developed to comply with door efficiency targets stipulated by the government in The Building Regulations 2010. The leaf has an insulated, internal rockwool core enabling it to achieve a U-value of 2.0, compliant with guidance of 2.0 for new dwellings and 2.2 for new commercial buildings. These door-sets meet the standards set out in the 2010 approved documents L1A and L2A.

### Typical Steeldor double emergency exit door-set specification

#### Rebate frame

(See Figs. 1 & 2) Typical door configuration consists standard rebate frame assembly, for either single or double door-sets. Made from lightweight, high tensile 'Rustec' steel and powder coat finish, it also has an "Adjust-2-Fit" side expander system that offers 6 adjustable fixing positions.

**Various frame depths and styles available - including double rebate frames (see frame specification sheet).**

**Manufactured from 1.6 mm thick 'Rustec' steel. Single rebate 104mm wide frame with additional rebate for flush lip.**

**A minimum of six fully adjustable fixing points are provided to each jamb - extra fixings available on request.**

**Unique 'Adjust-2-fit' side channels with each frame.**

#### Leaf

45mm door leaf thickness, fitted with a flush lipped astragal for added security. Comprising of 2 x 1.2mm 'Rustec' steel sheets, the leaf is internally bonded with a dutch fold stitch welded system providing greater stability and protection against de-lamination.

**Thermal rockwool core - 2.0 U-value.**

#### Industrial door threshold - 96mm

(See Fig. 3) Standard aluminium threshold is DDA approved and is fitted with a neoprene seal for outward opening door-sets.

Fig. 2 Rebate frame and Dutch fold leaf

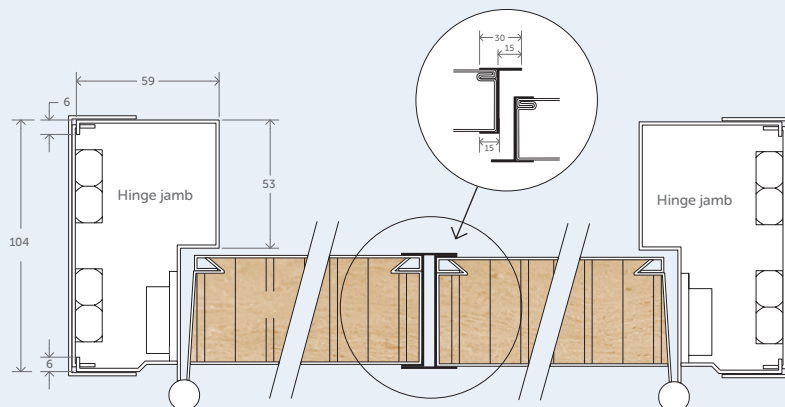

#### Door ironmongery

BS 7352 Grade 13 stainless steel, twin bearing template drilled butt hinges with integral high security dog bolts are fitted as standard with CE marking. Other hardware on request.

#### Finish

Supplied inclusive of a powder coated finish in a standard colour. Full range of RAL and BS colours available. Marine Grade finish as an option in salt laden coastal or high chlorination locations.

#### Seals

Strongdor self adhesive P-seal provided as standard.

#### Side panels and over panels (optional)

Solid, glazed and louvred side and over panels available.

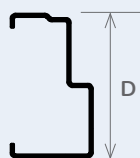

Fig. 1 Single rebate frame assembly

Size	Depth (D)
Min	80mm
Max	250mm

#### UNIQUE RANGE FEATURES

**10-12 day lead time**

**Up to 2.5m high\***

**1 year warranty**

**Same day quote**

**Thermal Rockwool Core**

**2.0 W/m<sup>2</sup>K U-value**



Double door	Size range
Width	700 to 2200mm
Height	450 to 2500mm*

\*NB - Structural height to 2.5m - certified 2.0 U-value to 2.25m.

**Larger bespoke sizes are also available in the Steeldor+ range. See specification sheet for details.**

Standard double emergency exit door configurations

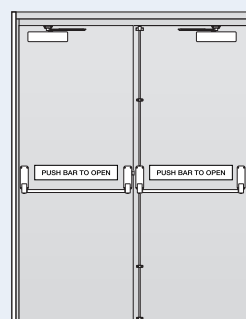

Other options on request.

Fig. 3 Industrial door threshold - 96mm

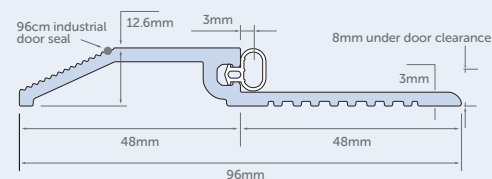

AM3, AM5, flat double ramped and specialist inward opening thresholds available on request.

**Steel<sup>dor</sup> thermal**

**EMERGENCY EXIT**

**DOUBLE STEEL DOOR-SET**

SUITABLE FOR INTERNAL / EXTERNAL USE



★★★★★ Trustpilot

T. 01524 727000 E. [sales@strongdor.com](mailto:sales@strongdor.com)  
[www.strongdor.com](http://www.strongdor.com)

